



Roller Blinds

Systems 32, 40 & 45



Macassar Roller Blinds use three different sizes of mechanism to provide excellent performance over a wide range of window sizes, fabric weights and thickness'.

The bigger and heavier the blind, the larger the system utilised. As the system size increases the diameter of the sprockets for the control chain increases enabling larger blinds to be operated with a minimum of effort.

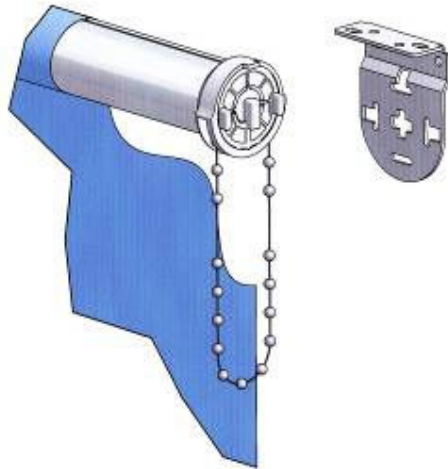

Universal brackets are sized to the mechanism allowing for face, top or side fix as well as right or left-hand controls.

The idle end has a spring-loaded pin that gives a positive location and copes with small variations in window size.

The 'universal' nature of the bracketry allows for immediate on-site changes to be made if, for example, a blind has been specified as right hand control prior to client occupation but needs to be left handed for ease of use. There are even extension brackets for system 32 giving a longer clearance for face fix applications.

Systems 32, 40 & 45 are suitable for use in any situation where operator ease of use, minimum maintenance and reliability are required. They are especially useful where a project has a wide variety of window sizes, or require different fabrics in the same area; yet robust ease of use is a prerequisite.

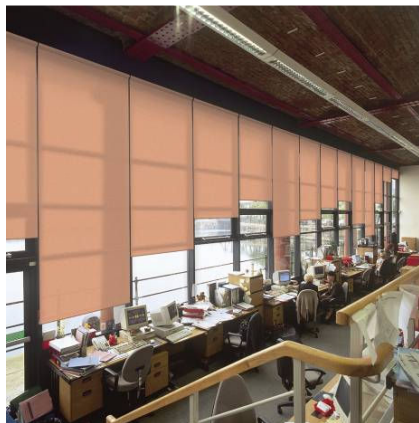

Under normal working conditions these systems should be almost maintenance free. The brackets are usually made of powder coated steel, though plastic ones are available for system 32, the tubes are extruded aluminium and the majority of the operating mechanism is Nylon 6.

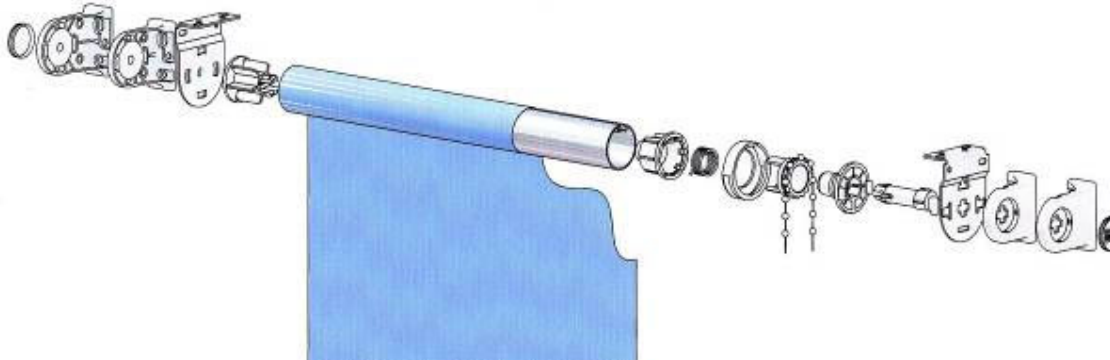

A wide range of fabrics can be specified, in an even greater variety of colours.

Dim-out fabric cuts glare, but still allows a good amount of light through. They are excellent for general use on all aspects of a building and offer the widest choice of colour.

Solar Protective fabrics (SPC) go further than dim-out by utilising a silvered backing to reflect some of the sun's heat back through the glass. These fabrics are especially useful at windows facing the full sun or where glare and heat gain are particular problems.

Blackout, as their name implies, do not allow light to travel through the fabric. These are usually the heavier fabrics and due to the level of light exclusion and the total lack of surface flare, these fabrics are well suited to computer facilities, laboratories or rooms where complete privacy or a good level of darkness are required.

SunScreen fabrics are manufactured from glass fibres and have an open weave. This means they filter out up to 99% of the incoming UV, yet still allow the occupants to maintain a view to the outside. The darker the colour used, the higher the level of optical clarity, yet the surface flare is reduced, meaning that blacks, browns and dark greys are excellent in highly populated areas where computers are used extensively.

We also have a range of anti-microbial fabrics developed especially for Hospitals and other 'clean' environments; please contact us for full details.

For use with the heaviest fabrics, for very wide blinds or for special applications, we have access to several other systems that utilise bigger tubes, geared operating mechanisms, spring assistance or electric motors to ensure smooth and easy operation.

To discuss a project in general or specific terms, please contact us and we will be happy to manage your need from initial enquiry to final delivery.



Sizes available:

Minimum Width:		300mm
Maximum Width:	Standard Systems	3000mm
Maximum Width:	Special Systems	6600mm
Maximum Drop:	Standard Systems	4000mm
Maximum Drop:	Special Systems	13000mm

Maximum sizes subject to fabric weight.

Horizontal joins on a cover may be required. Please enquire for specific fabric details and technical specification.

All Macassar Blinds Contract fabrics meet current flame retardancy regulations.

Macassar Blinds Ltd
7 Roman Way, Coleshill Industrial Estate
Birmingham. B46 1HG
Tel: +44 (0) 845 241 3820 Fax: +44 (0) 845 241 3821
www.macblinds.com